

Use only in place of 13W/5T4/GX23-2
 These retrofit kits are to be used in the office buildings, factories, shopping malls, schools, supermarkets, hotels, underground parking lots, subways, governmental projects and so on.

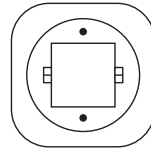

Specifications

Model	DAMAR 34378C
Watts	9W
Input Voltage	AC 120-277 60Hz / 120V 60Hz AC Magnetic Ballast
Color Temp	4100K
Power Factor	≥0.9
CRI	80
Lumen	800
Min - Max Temp	-40F – 104F
Base Type	GX23-2 (2-Pin)
Color	White
Life	50,000 Hours

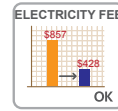

Big Savings (87%) on Electricity Costs



Damp Location Rated



Long Lifespan 10 Years



No Mercury No UV Light

Photometrics



Wiring Details

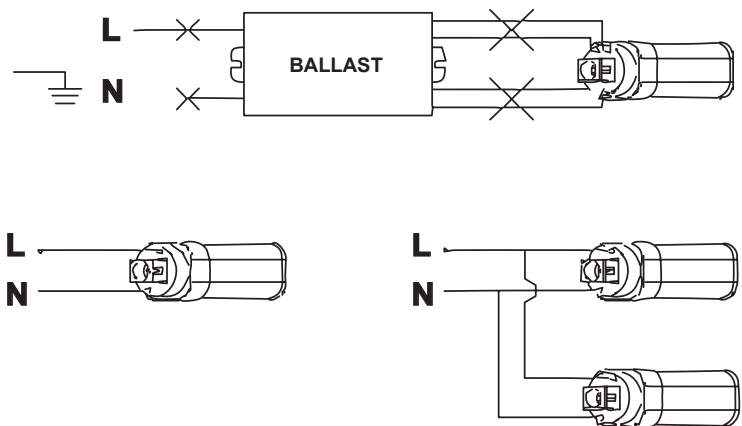

www.damar.com

34378C
 LED9TT/841/2P/DM
 LED Retrofit

Wattage: 9W
 CCT: 4100K
 CRI: 80
 Avg Hours: 50,000
 Avg Lumens: 800
 Voltage: 120-277V
 Hertz: 60Hz

DAMAR®
 805 N Carnation
 Aurora, MO 65605
 Made in China

WARNING

RISK OF SHOCK-DISCONNECT POWER BEFORE INSTALLATION.

The retrofit kit includes LED tube, instruction, field-applied label.

The PL LED tubes intended to retrofit maximum four lamps, type Non-IC or type IC recessed mounted fluorescent luminaires without diffuser that use straight tubular. The products intended to be used in damp locations only.

CAUTION - RISK OF FIRE. IF THE LED TUBE EXHIBITS UNDESIRABLE OPERATION (BUZZING,-FLICKERING, ETC.), IMMEDIATELY TURN OFF POWER, REMOVE LED TUBE FROM LUMINAIRE AND CONTACT MANUFACTURER.

CAUTION - RISK OF FIRE - IF INSTALLING THIS LAMP IN A PRE-HEAT LUMINAIRE, REMOVE THE AUTOMATIC STARTERS FROM THEIR HOLDERS BEFORE INSTALLING LAMP.

THIS LED TUBE OPERATES ON MAGNETIC BALLASTS AND LINE VOLTAGE. IF LAMP DOES NOT LIGHT WHEN THE LUMINAIRE IS ENERGIZED, REMOVE LED TUBE FROM LUMINAIRE AND CONTACT LED TUBE MANUFACTURER OR QUALIFIED ELECTRICIAN.

WARNING – Risk of fire or electric shock. LED Retrofit Kit installation requires knowledge of luminaires electrical systems. If not qualified, do not attempt installation. Contact a qualified electrician.

WARNING – Risk of fire or electric shock. Install this kit only in the luminaires that have the construction features and dimensions shown in the photographs and/or drawings.

Do not make or alter any open holes in an enclosure of wiring or electrical components during kit installation.

WARNING – To prevent wiring damage or abrasion, do not expose wiring to edges of sheet metal or other sharp objects.

WARNING: To avoid potential fire or shock hazard, do not use this retrofit kit in luminaires employing shunted bi-pin lampholders. Note: Shunted lamp holders are found only in fluorescent luminaires with Instant-Start ballasts. Instant-start ballasts can be identified by the words “Instant Start” or “I.S.” marked on the ballast. This designation may be in the form of a statement pertaining to the ballast itself, or may be combined with the marking for the lamps with which the ballast is intended to be used, for example F40T12/IS. For more information, contact the LED luminaire retrofit kit manufacturer.

“Installers should not disconnect existing wires from lampholder terminals to make new connections at lampholder terminals. Instead installers should cut existing lampholder leads away from the lampholder and make new electrical connections to lampholder lead wires by employing applicable connectors.

Installation

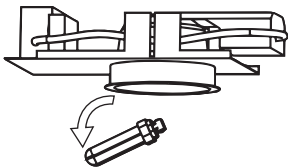

STEP 1

Take out the original ballast.

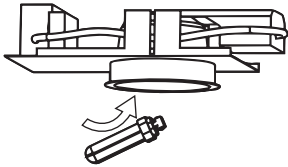

STEP 2

Put the LED Plug-in lamp into the lampshade.

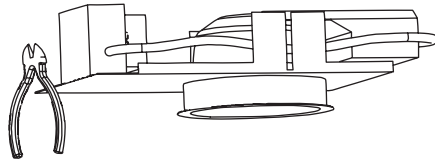

STEP 3

Bypass existing HF Ballast and rewire according to the following diagrams. Fuse not supplied. Insert the lamp with AC mains supplied to the corresponding end. To install the lamp in the wrong direction will lead to malfunction.

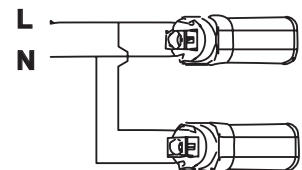
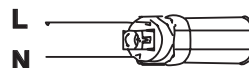

www.damar.com

34378C LED Retrofit



Wattage: 9W
CCT: 4100K
CRI: 80
Avg Hours: 50,000
Avg Lumens: 800
Voltage: 120-277V
Hertz: 60Hz

DAMAR[®]
805 N Carnation
Aurora, MO 65605
Made in China