

**WARNING: Risk of Fire or Electric Shock**  
Installation of this LED Retrofit Kit requires expertise in luminaire electrical systems. Do not attempt installation unless you are qualified. If in doubt, contact a licensed electrician.

**WARNING: Risk of Fire or Electric Shock**  
Install this kit only in luminaires that conform to the construction features and dimensions specified in the provided photographs or drawings. Ensure the input rating of this retrofit kit does not exceed that of the luminaire.

Do not create or modify any open holes in the enclosure of wiring or electrical components during installation.

**WARNING: To Prevent Wiring Damage or Abrasion**  
Do not expose wiring to the edges of sheet metal or other sharp objects.

Installers must not disconnect existing wires from lamp holder terminals to make new connections. Instead, cut the existing lamp holder leads and use appropriate connectors to establish new electrical connections to the lamp holder lead wires.

This product is rated :SUITABLE FOR WET LOCATIONS.

**WARNING: Risk of Fire or Electric Shock**  
Do not alter, relocate, or remove wiring, lamp holders, power supply, or any other electrical components.

The Retrofit Kit is accepted as a component of a luminaire. The suitability of the combination must be determined by the authorities having jurisdiction.

This device is NOT intended for use with emergency exits.

Ambient Operating Temperature: -13°F to 104°F (-25°C to 40°C).  
Suitable for wet locations.  
Suitable for an insulated ceiling.  
Type IC rated for direct contact with insulation.  
Triac dimmable.

**ELECTRICAL PARAMETERS**

Model	Input Voltage (V)	Input Frequency (Hz)	Input Current (A)	Input Wattage (W)
39660A	120V	60Hz	0.055A/ 0.07A/ 0.085A	6W/ 8W/ 10W

**Dimensions:**  
**Unit: in/mm**

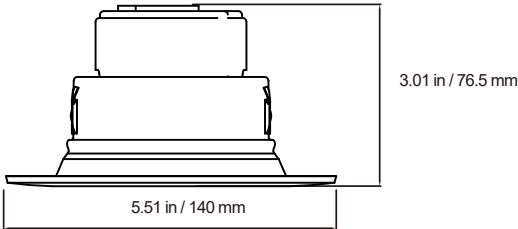

Dimension Tolerance: ±0.05 in / 1.5 mm

**STEPS**

**Before Installation:**  
Select the desired CCT (Correlated Color Temperature) and Wattage by adjusting the switch located on the back of the device.

**Step 1: Turn off the power before installation.**  
If necessary, remove the diffuser and the existing bulb, then remove the existing trim. Attach the Modified Luminaire Sticker to the inside of the recessed luminaire housing.

**Step 2: As shown in Figure 1.**  
Twist the lamp base into the lamp holder until securely fastened.

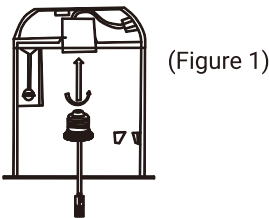

**Step 3: As shown in Figure 2.**  
Connect the lamp connector to the lamp base connector until they are securely joined.

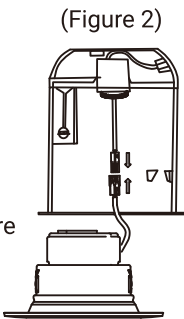

**Step 4: As shown in Figure 3.**  
Push the LED retrofit trim into the recessed light fixture, allowing the mounting clips to secure the LED trim into place. Continue pushing until the outer edge of the trim is flush with the ceiling surface.

